



## Precision Electric Slides/GXYR Series

XY $\theta$  Three-axes All-in-one Electric Slides  
Multi-point Positioning Control



## Precision XY $\theta$ Electric Slides Three-axes All-in-one

## ■ GX YR Model Code

Series	Size	XY Stroke	R Angle	Motor
<b>GXYR</b>	<b>80</b>	<b>15</b>	<b>10</b>	<b>OS</b>
	80: 80mm	15: ±15mm	10: ±10°	OS: Open Loop Stepper Motor
	120: 120mm	25: ±25mm	360: 360°	

### ■ Model Selection

Screw Feed Distance:  $L = \sin\theta \cdot R$

Worktable Rotation Angle:  $\theta = \sin(L/R)$

R = Rotary Wheelbase

L = Screw Feed Distance

### GXYR80-15-10-OS

Demonstration of worktable rotation angle calculation

$$\theta = \arcsin(1\text{mm}/55.5\text{mm}) = 1.03241^\circ$$

Demonstration of screw feed distance calculation

$$L = \sin(1.03241^\circ) \times 55.5\text{mm} = 1\text{mm}$$

Item	Model				
	GXYR80-15-10-OS	GXYR80-15-360-OS	GXYR120-25-360-OS		
Table Size	mm	80	80	120	
X Axis Stroke	mm	±15	±15	±25	
Y Axis Stroke	mm	±15	±15	±25	
R Angle	°	±10	360		
Transmission Way		Screw Drive			
Guide XY Axes		Cross Roller Guides			
Guide Bearing		Cross Roller Bearings			
Flatness	mm	0.02			
Stroke/ Gear Ratio	X Axis	mm	1	1	2
	Y Axis	mm	1	1	2
	R Axis	mm	1	90:1	90:1
Repeatability	X Axis	µm	2		
	Y Axis	µm	2		
	R Axis	°	±0.005		
Face Runout	mm	0.005			
Side Face Runout	mm	0.005			
Suggested Dynamic Load	kg	Horizontal Installation ≤ 15		Horizontal Installation ≤ 30	
Weight	kg	1.8	2.8	6.5	

## ■ GX YR80-15-10-OS

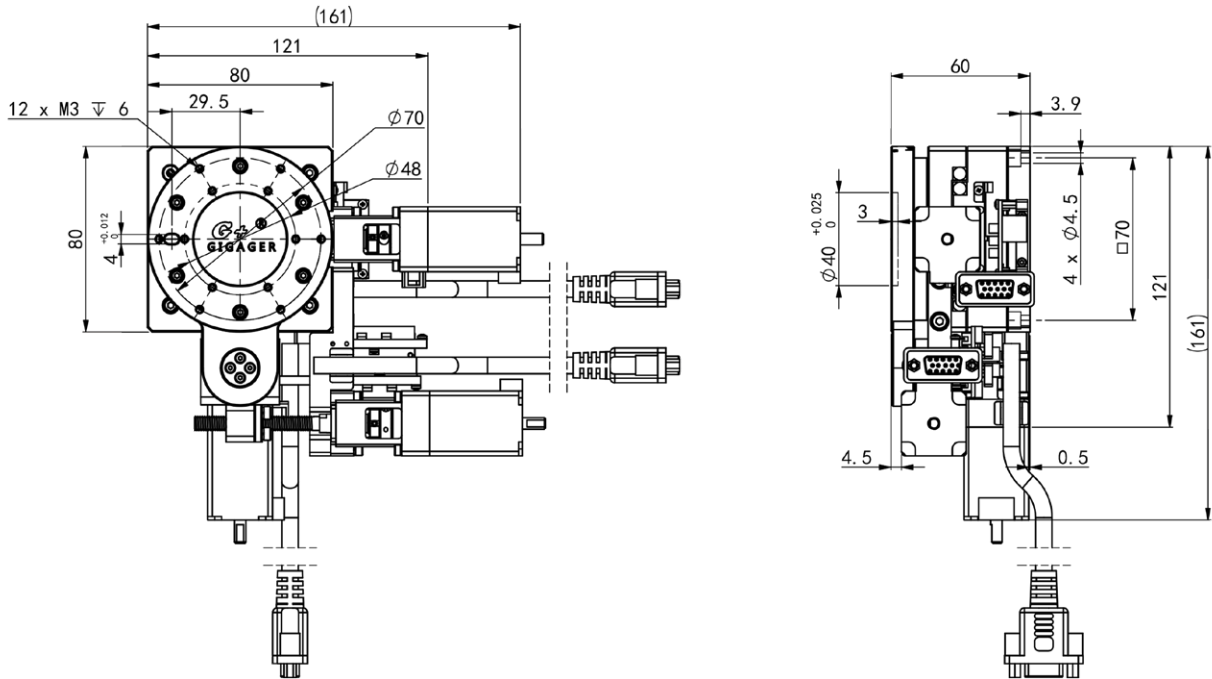

## ■ GX YR80-15-360-OS

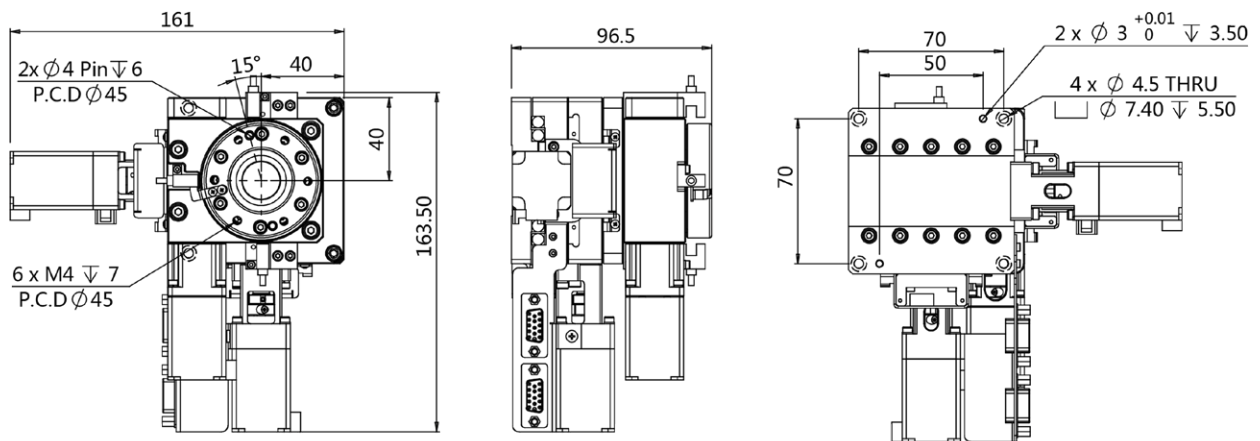

XXY
<b>GXYR</b>
GX
GZ
GTZ
GXY
GR
GYH
GSH
GSR
GSHR
GSA
GSN
GSB
GSG
Parameter
GSZ
GMR
GMC
GMA
GML

■ GX YR120-25-360-OS

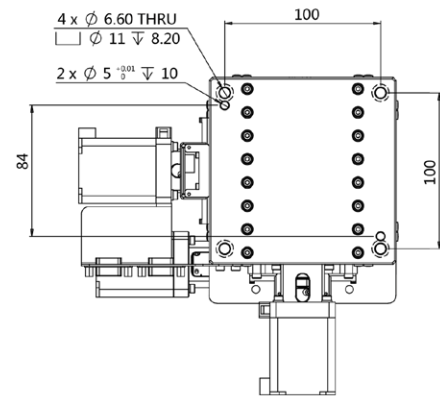
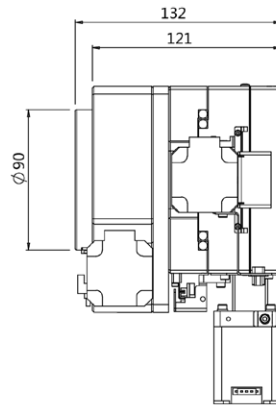
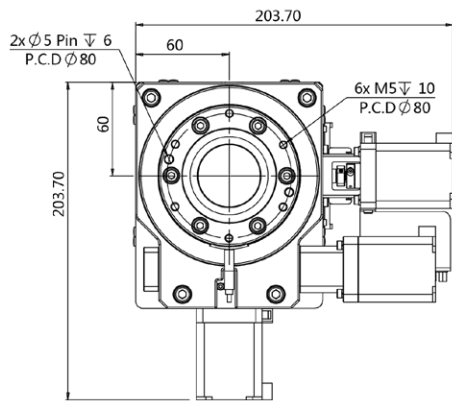

XXY
<b>GXYR</b>
GX
GZ
GTZ
GXY
GR
GYH
GSH
GSR
GSHR
GSA
GSN
GSB
GSG
Parameter
GSZ
GMR
GMC
GMA
GML



## Precision Electric Slides/GX Series

Suit for X-axis Linear Motion  
Multi-point Positioning Control



## Precision X-Axis Electric Slides

# GX Model Code

	<b>GX</b>	<b>40</b>	<b>-</b>	<b>6.5</b>	<b>L</b>	<b>-</b>	<b>B28</b>
	Series	Size		Stroke	Outlet Direction		Motor
	X Axis	40: 40×40mm		6.5: ±6.5mm	L: Left		B28: Dedicated 28 Open Loop Stepper Motor
XXY		60: 60×60mm		15: ±15mm	R: Right		B42: Dedicated 42 Open Loop Stepper Motor
GXYR		80: 80×80mm		20: ±20mm			BC28: Dedicated 28 Closed Loop Stepper Motor
<b>GX</b>		100: 100×100mm		25: ±25mm			BC42: Dedicated 42 Closed Loop Stepper Motor
GZ		120: 120×120mm		35: ±35mm			B28C1: 28 Servo Motor Connector Φ5-Φ22-Φ32.53-Φ3
GTZ		150: 150×150mm		45: ±45mm			B42C1: 42 Stepper Motor Connector Φ5-Φ22-Φ43.84-Φ3.5
GXY							S05C1: 50W Servo Motor Connector Φ8-Φ30-Φ45-M3
GR							S05C2: 50W Servo Motor Connector Φ8-Φ30-Φ46-M4
GYH							
GSH							
GSR							
GSHR							
GSA							
GSN							
GSB							
GSG							
Parameter							
GSZ							
GMR							
GMC							
GMA							
GML							

## Technical Parameters

Parameters	Model						
	GX40-6.5L GX40-6.5R	GX60-15L GX60-15R	GX80-20	GX100-25	GX120-35	GX150-45	
Table Size	mm	40×40	60×60	80×80	100×100	120×120	150×150
Base Size	mm	40×40	60×60	80×80	100×100	120×120	150×150
Height	mm	30	30	40	42	45	44
Stroke	mm	±6.5	±15	±20	±25	±35	±45
One-way Repeatability	mm	±0.001					
Flatness	mm	0.03					
Screw Stroke	mm	1			2		
Suggested Dynamic Load	Horizontal Installation	≤ 10	≤ 30	≤ 50			
	Vertical Installation	≤ 5	≤ 7	≤ 20			
Static Load	kg	≤ 60	≤ 60	≤ 100			
Surface Treatment		Black Anodized					
Weight (no motor)	kg	0.22	0.41	0.65	1.3	1.8	2.6

\* This promotional material is for consultation only, if the information does not match the product entity, the product entity shall prevail, if you have any questions please contact our sales representative  
If there are any upgrades or changes to the product's structure, specifications, dimensions, or parameters, we will not notify you further. Thanks for your understanding

## ■ GX40-6.5L

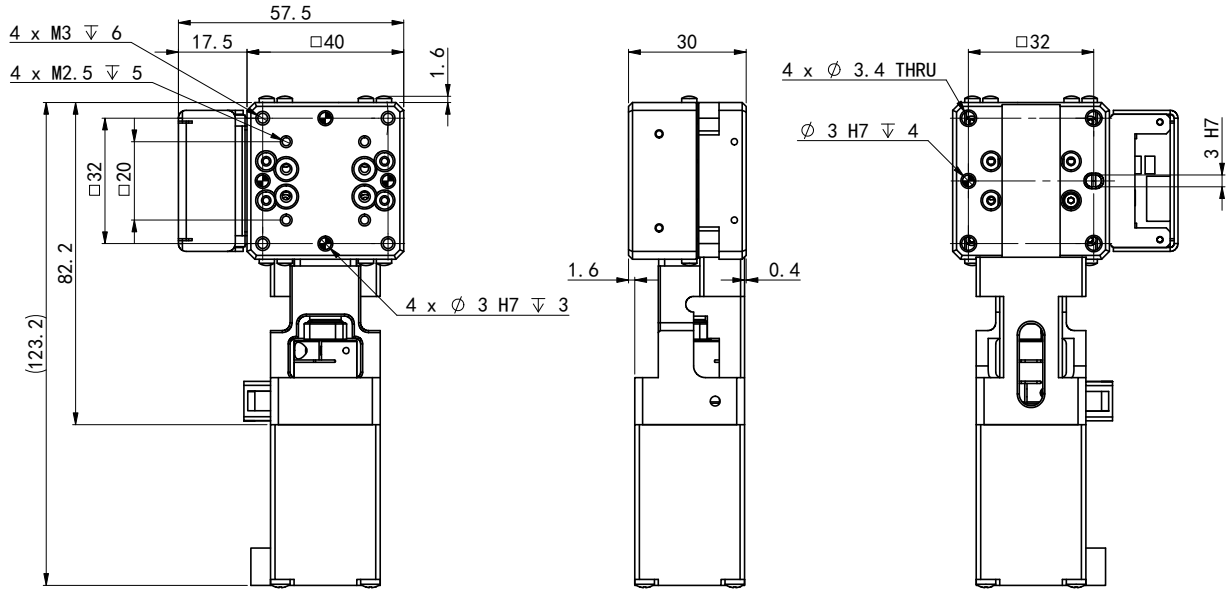

## ■ GX40-6.5R

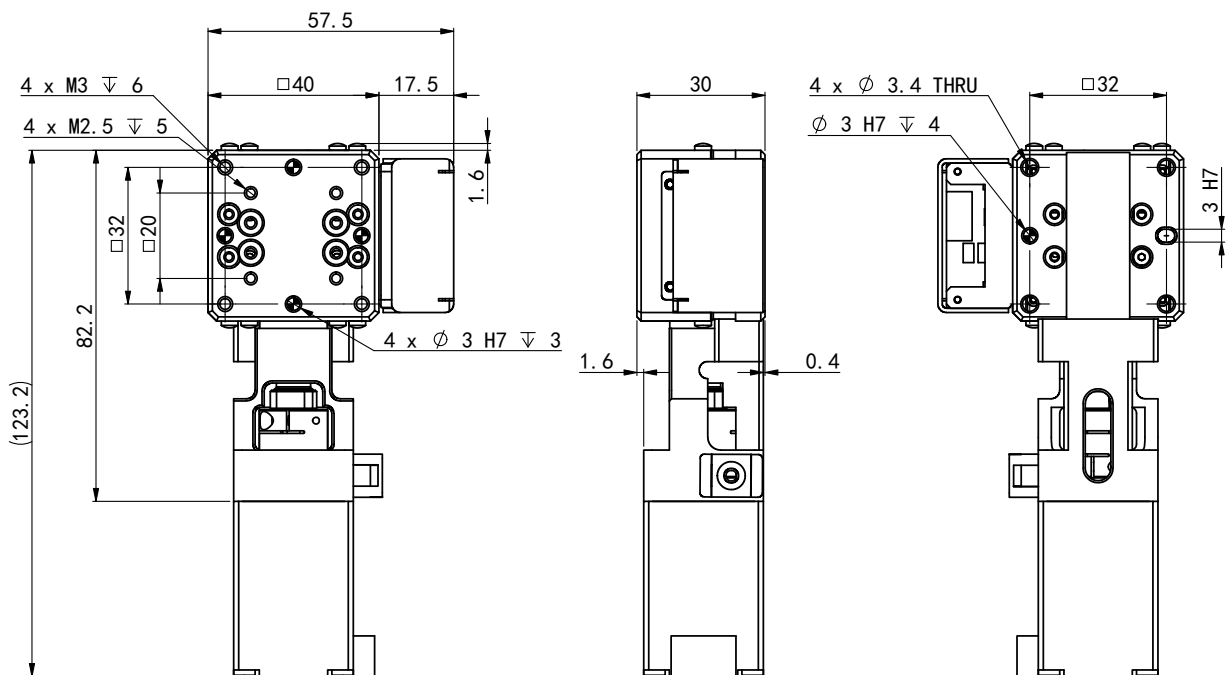

XXY
GXYR
<b>GX</b>
GZ
GTZ
GXY
GR
GYH
GSH
GSR
GSHR
GSA
GSN
GSB
GSG
Parameter
GSZ
GMR
GMC
GMA
GML

■ GX60-15L

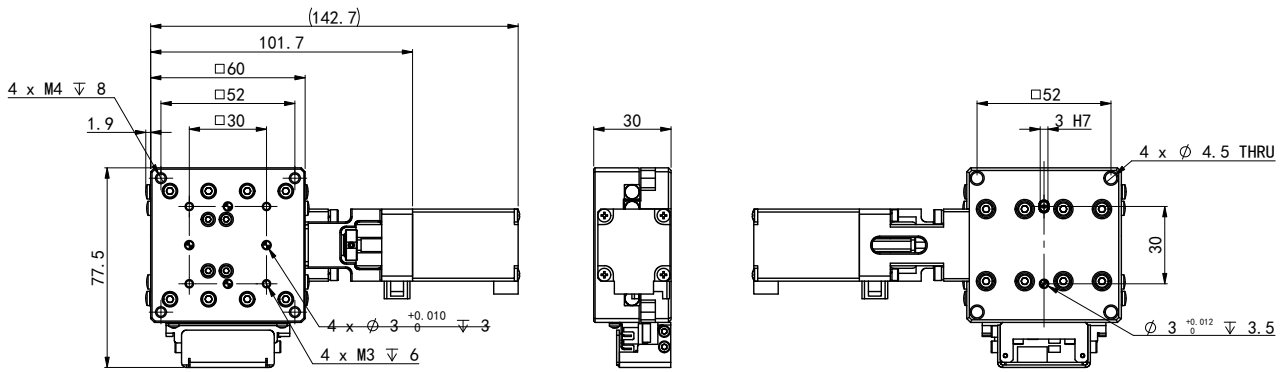

■ GX60-15R

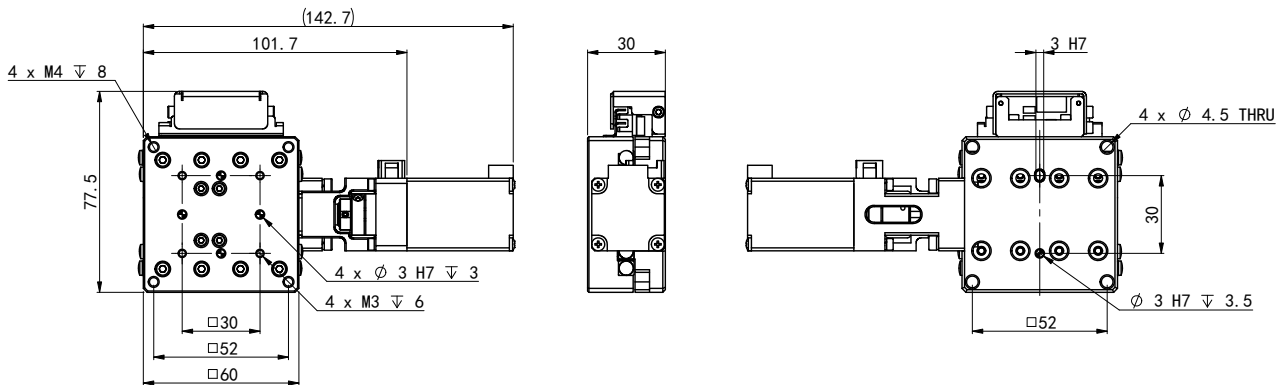

XXY
GXYR
<b>GX</b>
GZ
GTZ
GXY
GR
GYH
GSH
GSR
GSHR
GSA
GSN
GSB
GSG
Parameter
GSZ
GMR
GMC
GMA
GML

## ■ GX80-20

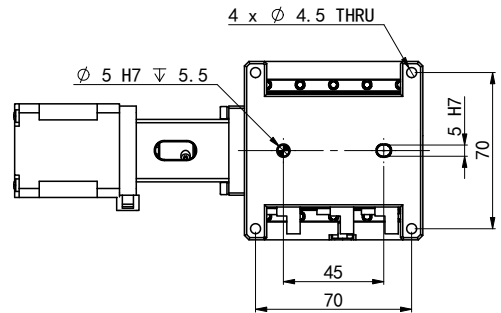
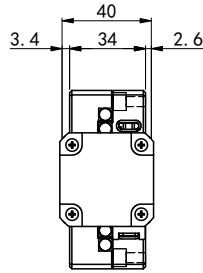
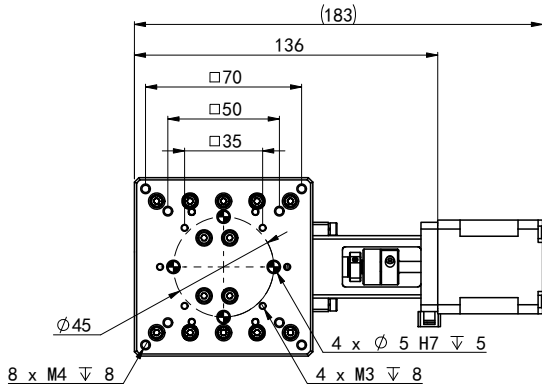

## ■ GX100-25

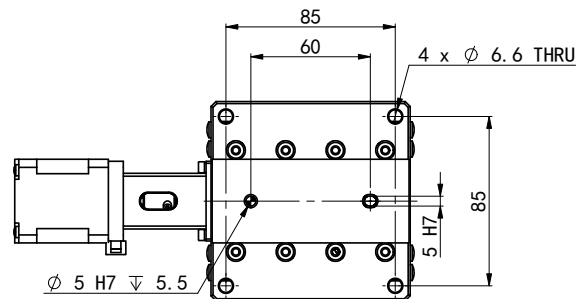
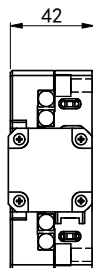
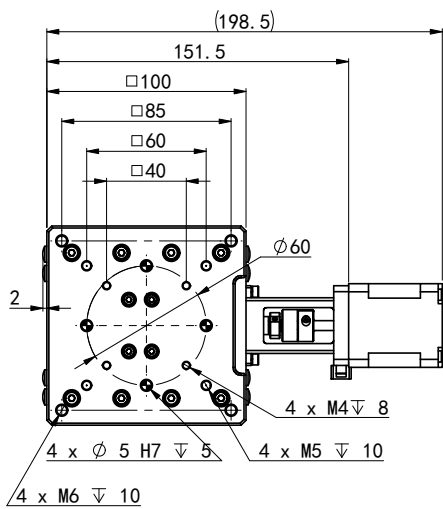

XXY
GXYR
<b>GX</b>
GZ
GTZ
GXY
GR
GYH
GSH
GSR
GSHR
GSA
GSN
GSB
GSG
Parameter
GSZ
GMR
GMC
GMA
GML

■ GX120-35

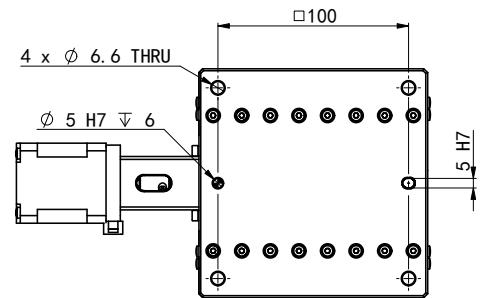
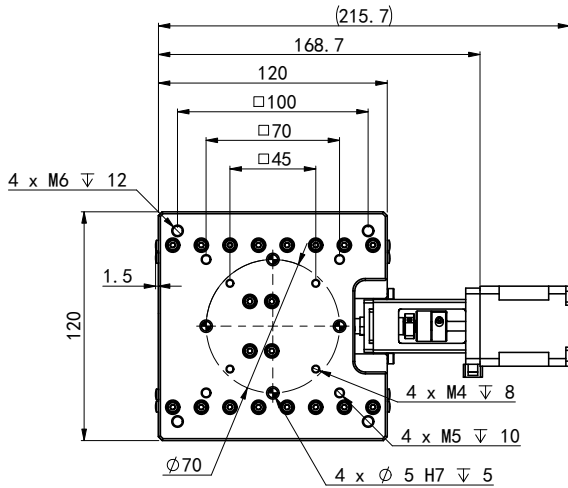

■ GX150-45

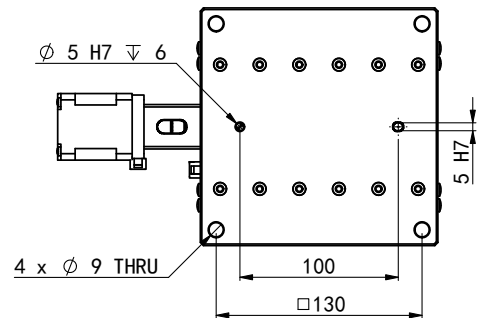
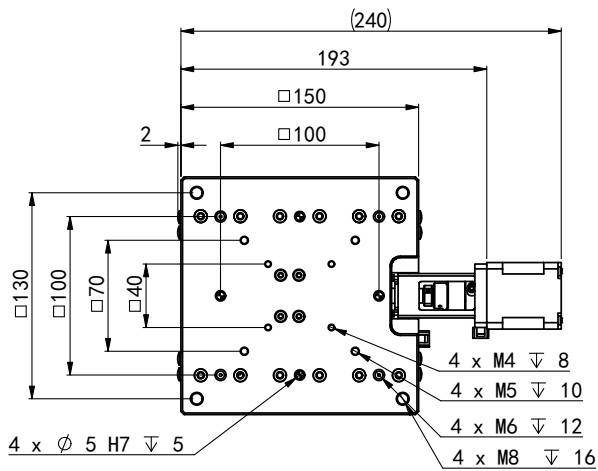

XXY
GXYR
<b>GX</b>
GZ
GTZ
GXY
GR
GYH
GSH
GSR
GSHR
GSA
GSN
GSB
GSG
Parameter
GSZ
GMR
GMC
GMA
GML



## Precision Electric Slides/GZ Series

Suit for Z-axis Linear Motion  
Multi-point Positioning Control

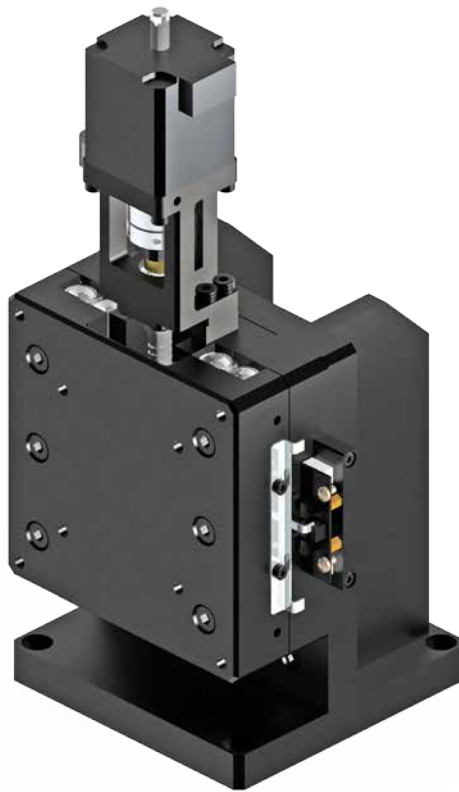

## Precision Z-Axis Electric Slides

# GZ Model Code

	<b>GZ</b>	<b>40</b>	-	<b>6.5</b>	<b>L</b>	-	<b>B28C</b>
	Series	Size		Stroke	Outlet Direction		Motor
	Z Axis	40: 40×40mm		6.5: ±6.5mm	L: Left		B28: Dedicated 28 Open Loop Stepper Motor
XXY		60: 60×60mm		15: ±15mm	R: Right		B42: Dedicated 42 Open Loop Stepper Motor
GXYR		80: 80×80mm		20: ±20mm			B28C1: 28 Stepper Motor Connector Φ5-Φ22-Φ32.53-Φ3
GX		100: 100×100mm		25: ±25mm			B42C1: 42 Stepper Motor Connector Φ5-Φ22-Φ43.84-Φ3.5
<b>GZ</b>		120: 120×120mm		35: ±35mm			S05C1: 50W Servo Motor Connector Φ8-Φ30-Φ45-M3
GTZ		150: 150×150mm		45: ±45mm			S05C2: 50W Servo Motor Connector Φ8-Φ30-Φ46-M4
GXY							
GR							
GYH							
GSH							
GSR							
GSHR							
GSA							
GSN							
GSB							
GSG							
Parameter							
GSZ							
GMR							
GMC							
GMA							
GML							

## Technical Parameters

Parameters	Model						
	GZ40-6.5L GZ40-6.5R	GZ60-15L GZ60-15R	GZ80-20	GZ100-25	GZ120-35	GZ150-45	
Table Size	mm	40×40	60×60	80×80	100×100	120×120	150×150
Base size	mm	40×40	60×60	80×80	100×100	120×120	150×150
Stroke	mm	±6.5	±15	±20	±25	±35	±45
One-way Repeatability	mm	±0.001					
Verticality	mm	0.03					
Screw Lead	mm	1			2		
Suggested Dynamic Load	kg	≤ 5	≤ 7	≤ 20			
Static Load	kg	≤ 30	≤ 60	≤ 100	≤ 150	≤ 100	-
Surface Treatment		Black Anodized					
Weight (no motor)	kg	0.3	0.63	1.05	2.1	2.93	4.3

\* This promotional material is for consultation only, if the information does not match the product entity, the product entity shall prevail, if you have any questions please contact our sales representative  
If there are any upgrades or changes to the product's structure, specifications, dimensions, or parameters, we will not notify you further. Thanks for your understanding

■ GZ40-6.5L

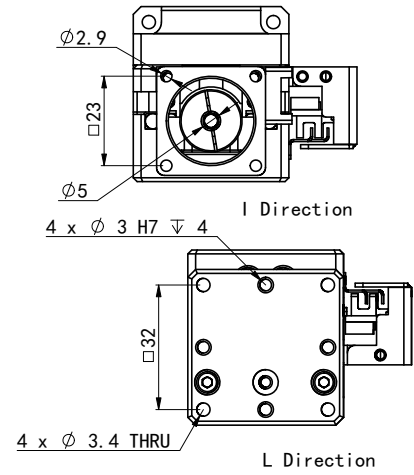
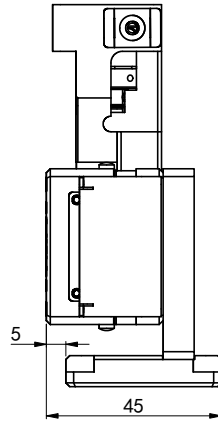
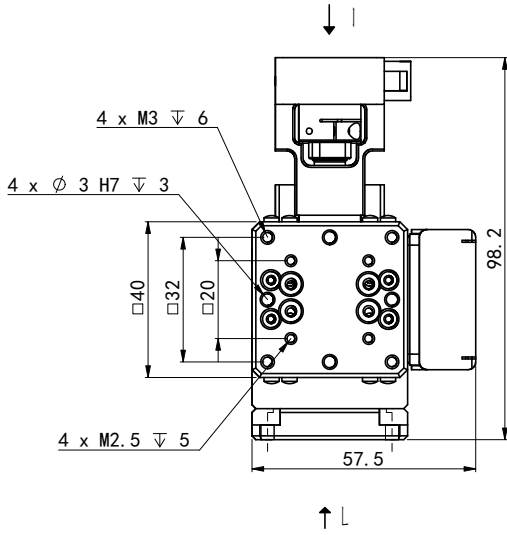

■ GZ40-6.5R

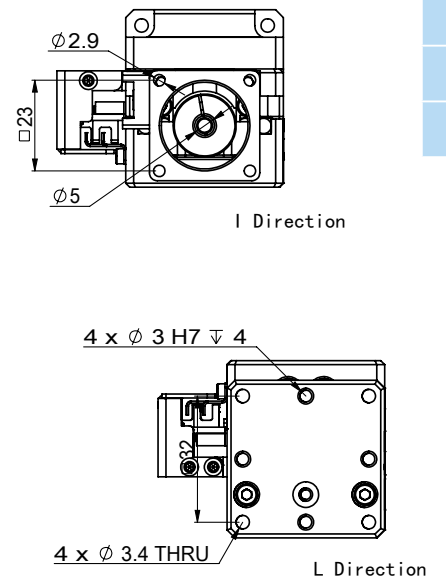
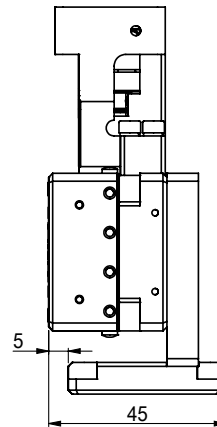
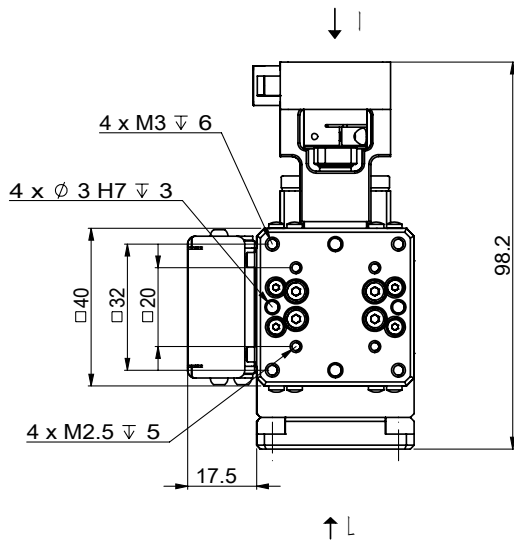

XXY
GXYR
GX
<b>GZ</b>
GTZ
GXY
GR
GYH
GSH
GSR
GSHR
GSA
GSN
GSB
GSG
Parameter
GSZ
GMR
GMC
GMA
GML

■ GZ60-15L

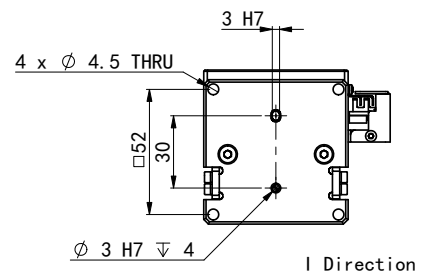
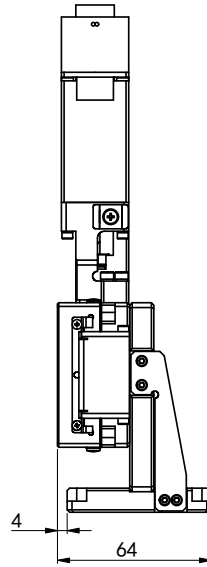
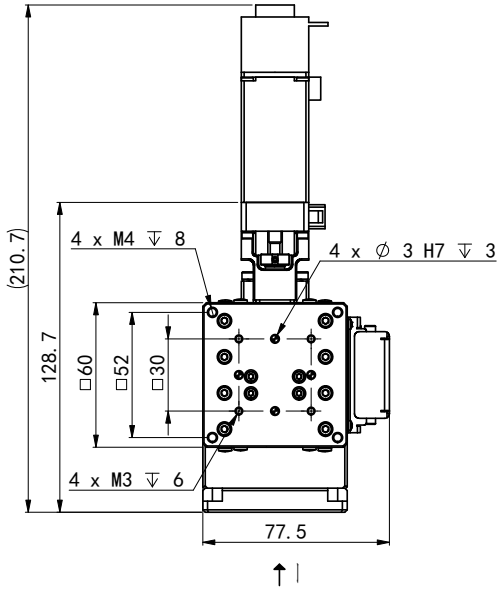

■ GZ60-15R

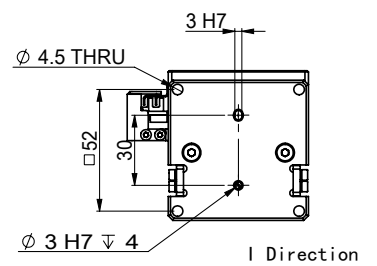
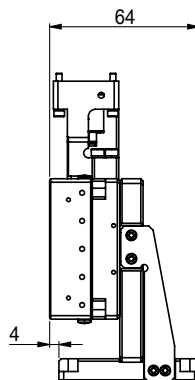
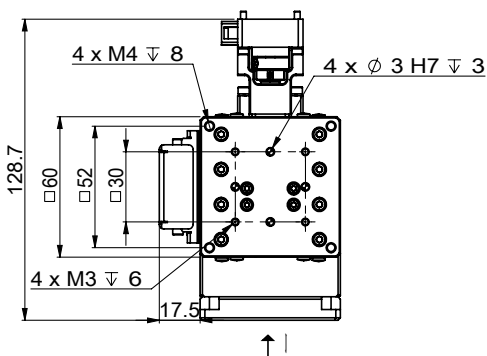
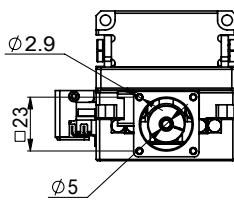

■ GZ80-20

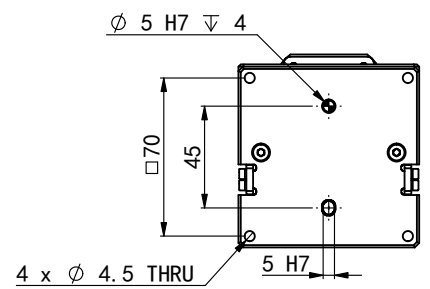
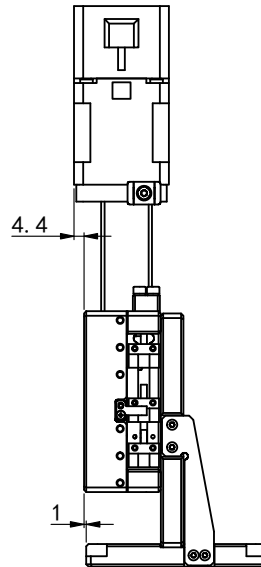
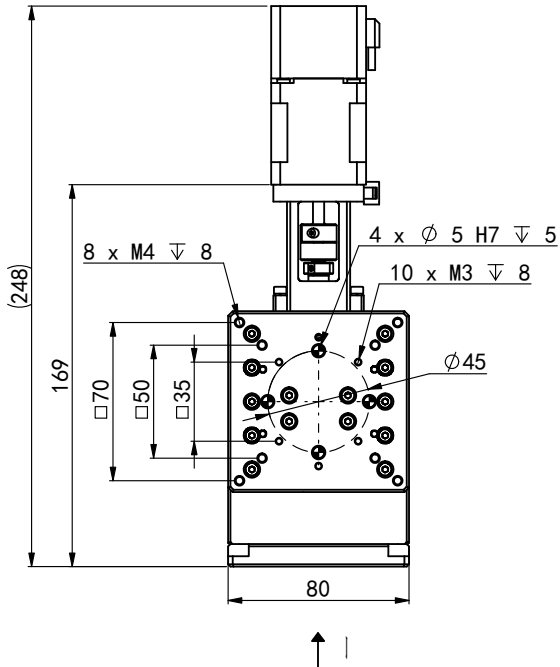

■ GZ100-25

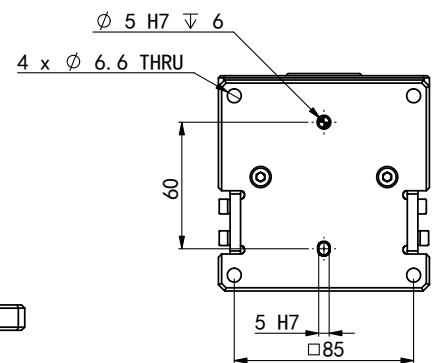
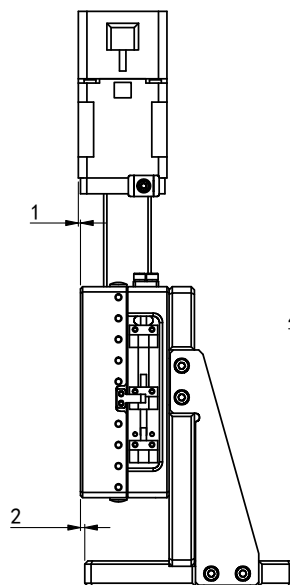
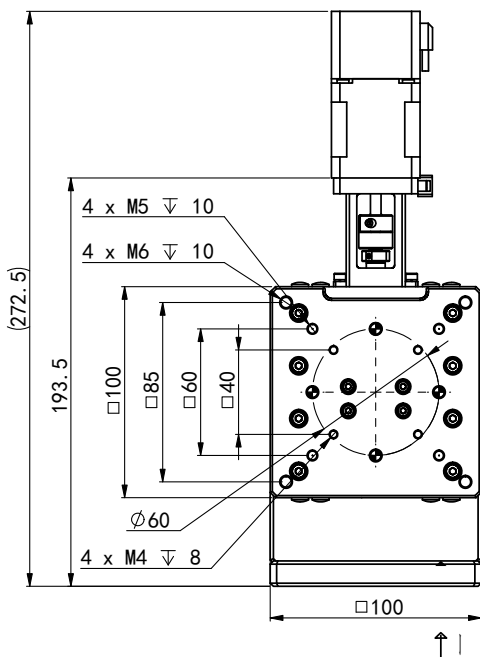

XXY
GXYR
GX
<b>GZ</b>
GTZ
GXY
GR
GYH
GSH
GSR
GSHR
GSA
GSN
GSB
GSG
Parameter
GSZ
GMR
GMC
GMA
GML

■ **GZ120-35**

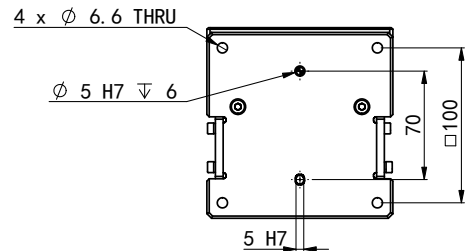
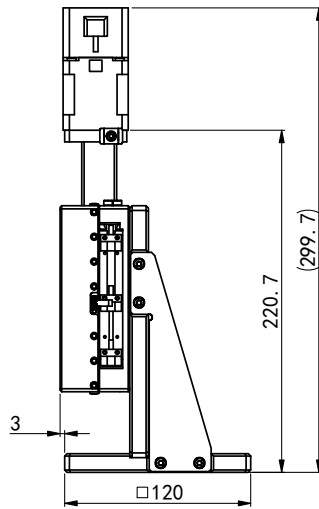
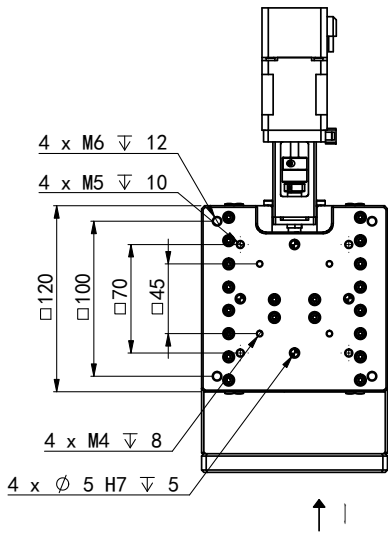

I Direction

■ **GZ150-45**

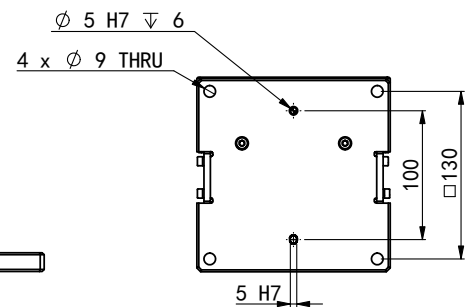
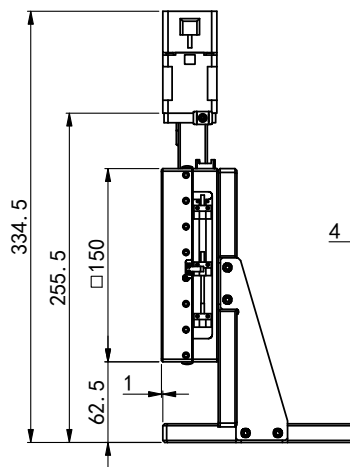
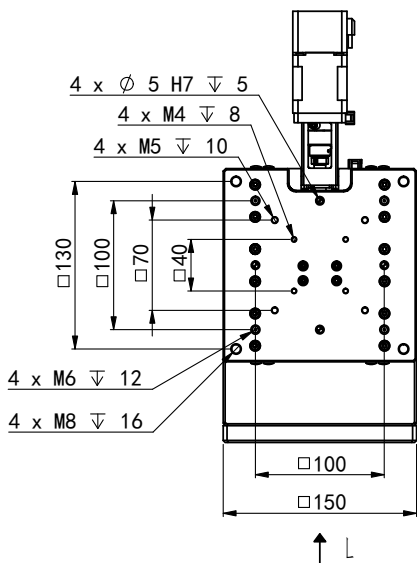

L Direction

XXY
GXYR
GX
<b>GZ</b>
GTZ
GXY
GR
GYH
GSH
GSR
GSHR
GSA
GSN
GSB
GSG
Parameter
GSZ
GMR
GMC
GMA
GML



## Precision Electric Slides/GTZ Series

Joint Application of Oblique Deed & Slider  
Z-axis Motion & Multi-point Positioning Control

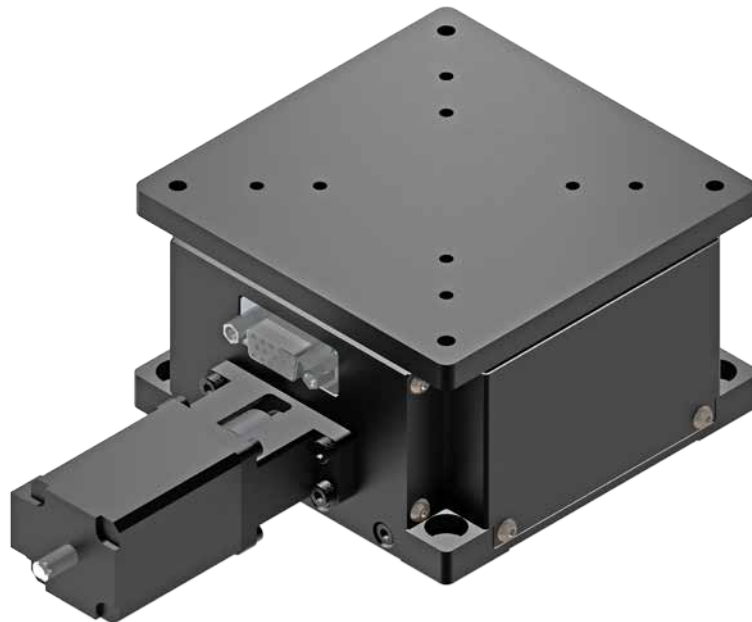

## Precision Oblique Deed Z Axis Electric Slides

# GTZ Model Code

	GTZ	80	-	10	-	B28C
	Series	Size		Stroke		Motor
XXY	Z Axis	80: 80×80mm		10: 0-10mm		B28C1: 28 Stepper Motor Connector Φ5-Φ22-Φ32.53-Φ3
GXYR		100: 100×100mm		20: 0-20mm		B42C1: 42 Stepper Motor Connector Φ5-Φ22-Φ43.84-Φ3.5
GX		120: 120×120mm		25: 0-25mm		S10C2: 100W Servo Motor Connector Φ8-Φ30-Φ50-M4
GZ		150: 150×150mm		40: 0-40mm		S20C2: 200W Servo Motor Connector Φ14-Φ50-Φ70-M5
<b>GTZ</b>		200: 200×200mm		45: 0-45mm		S20C3: 200W Servo Motor Connector Φ11-Φ50-Φ70-M4
GXY						S40C1: 400W Servo Motor Connector Φ14-Φ50-Φ70-M4
GR						S40C2: 400W Servo Motor Connector Φ14-Φ50-Φ70-M5
GYH						
GSH						
GSR						

## Technical Parameters

Parameters	Model					
	GTZ80-10-B28C	GTZ100-20-B28C	GTZ120-25-B42C	GTZ150-40-S10C2	GTZ200-45-S20C	
Table Size	mm	80×80	100×100	120×120	150×150	200×200
Base Size	mm	80×80	100×100	120×120	150×150	210×200
Height	mm	60	60	75	90	120
Stroke	mm	0-10	0-20	0-25	0-40	0-45
One-way Repeatability	mm	±0.001		±0.002		±0.003
Gear Ratio		1 : 2				
Verticality	mm	0.01				0.02
Screw Lead	mm	1		2		
Suggested Dynamic Load	kg	≤ 10	≤ 10	≤ 15	≤ 50	≤ 100
Static Load	kg	≤ 60	≤ 80	≤ 100	≤ 100	≤ 150
Surface Treatment		Black Anodized				
Weight (no motor)	kg	0.83	1.35	2.9	3.6	8.5

\* This promotional material is for consultation only, if the information does not match the product entity, the product entity shall prevail, if you have any questions please contact our sales representative  
If there are any upgrades or changes to the product's structure, specifications, dimensions, or parameters, we will not notify you further. Thanks for your understanding

## ■ GTZ80-10-B28C

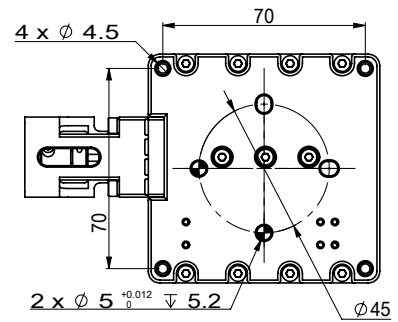
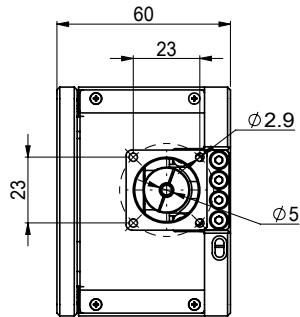
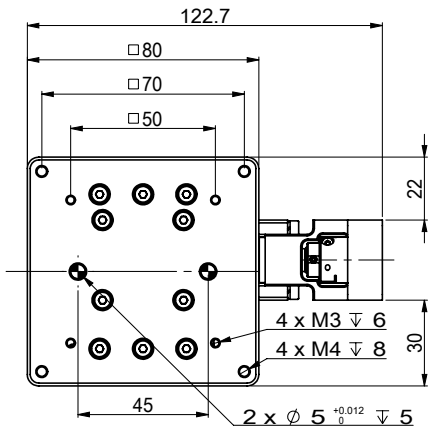

## ■ GTZ100-20-B28C

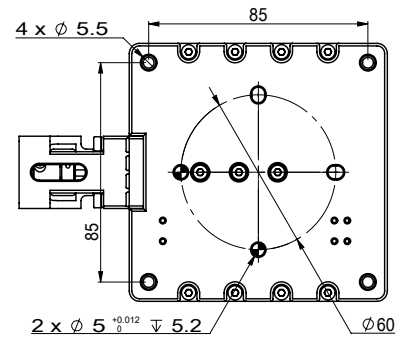
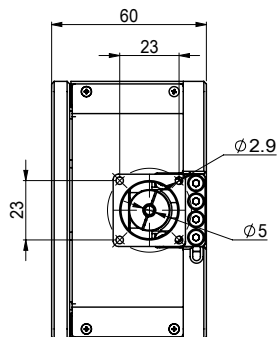
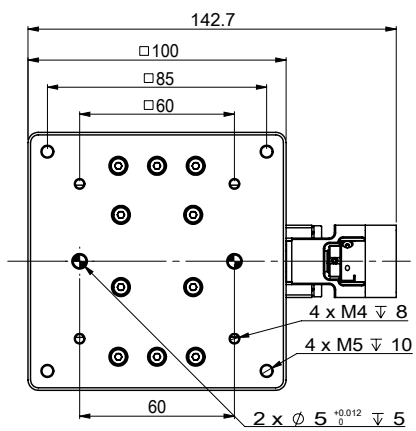

XXY
GXYR
GX
GZ
<b>GTZ</b>
GXY
GR
GYH
GSH
GSR
GSHR
GSA
GSN
GSB
GSG
Parameter
GSZ
GMR
GMC
GMA
GML

■ GTZ120-25-B42C

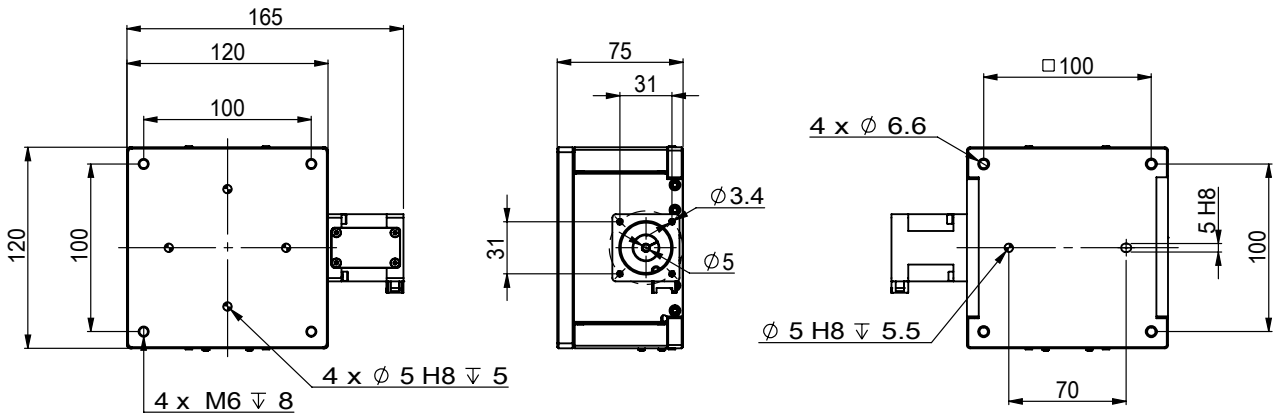

■ GTZ150-40-S10C2

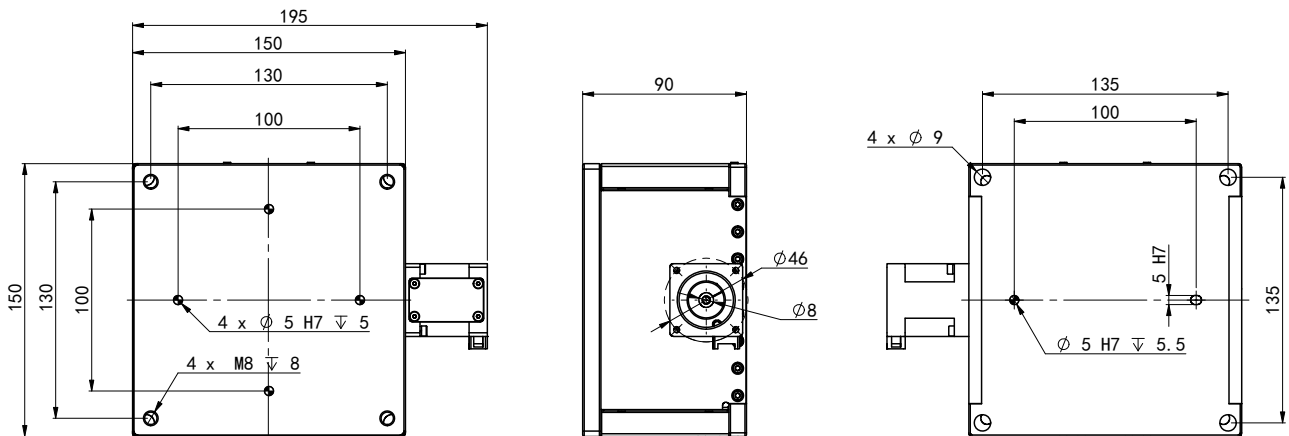

# GTZ200-45-S20C

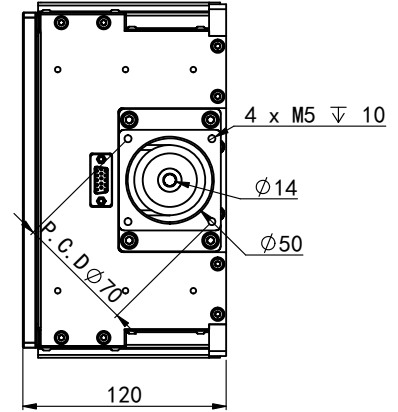
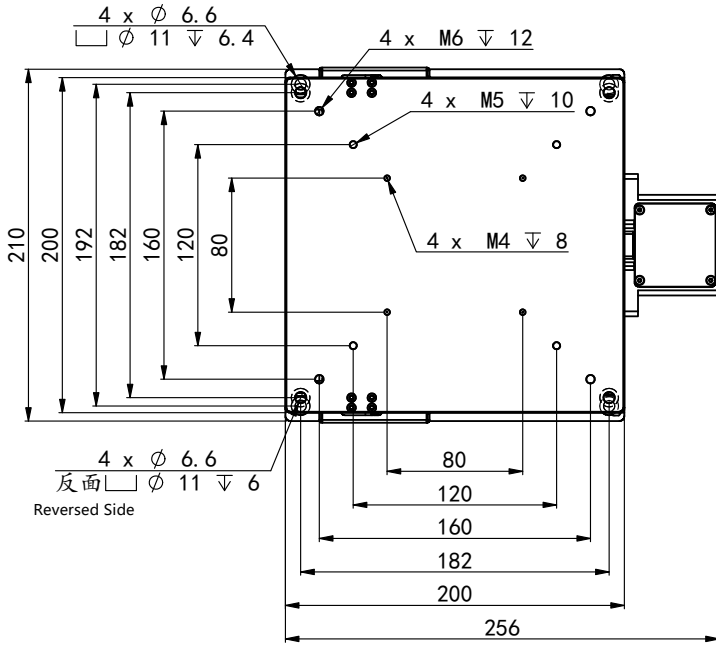

XXY
GXYR
GX
GZ
<b>GTZ</b>
GXY
GR
GYH
GSH
GSR
GSHR
GSA
GSN
GSB
GSG
Parameter
GSZ
GMR
GMC
GMA
GML

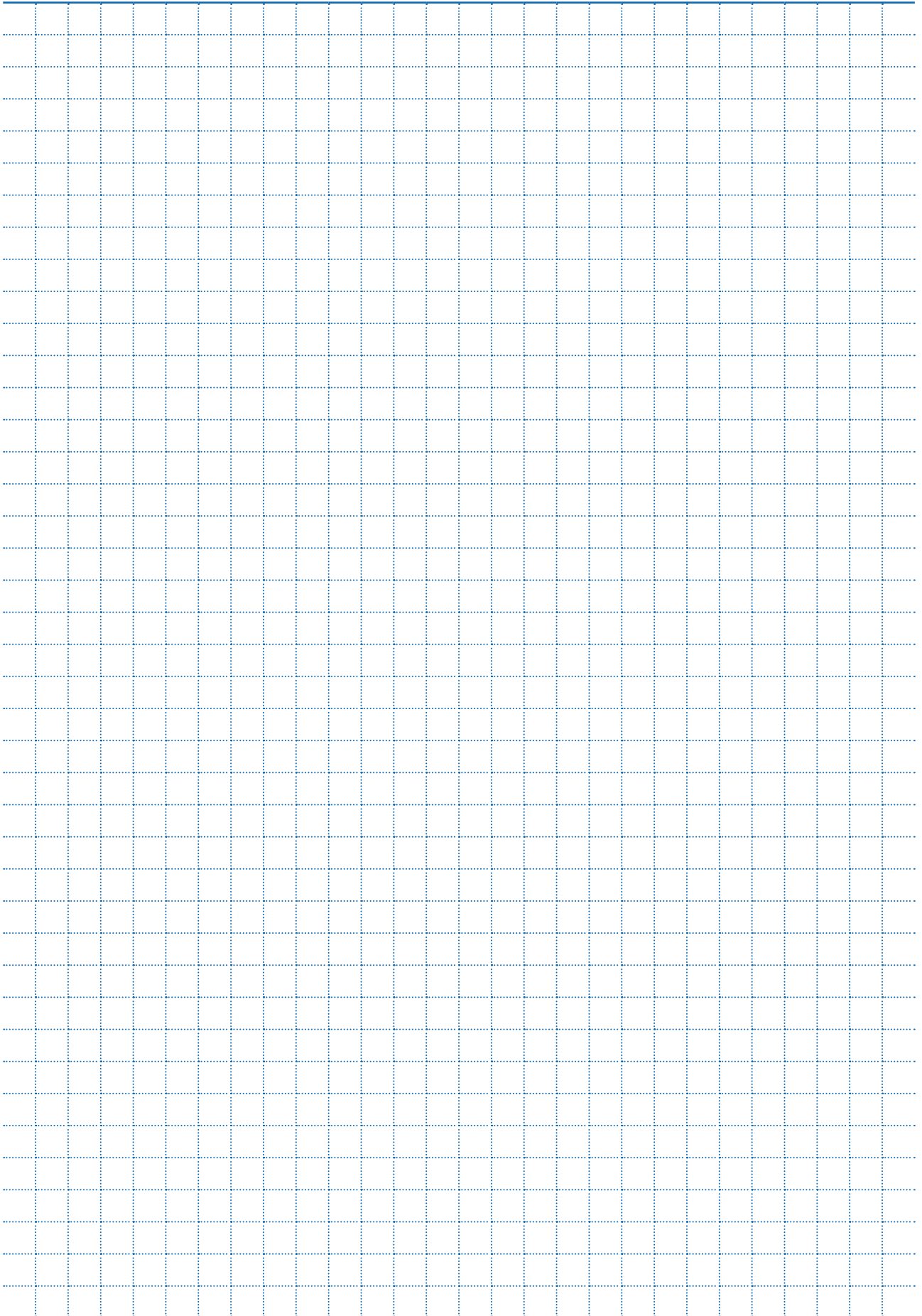



®

## Precision Electric Slides/GXY Series

Suit for Combined Motion of X-axis & Y-axis  
Multi-point Positioning Control

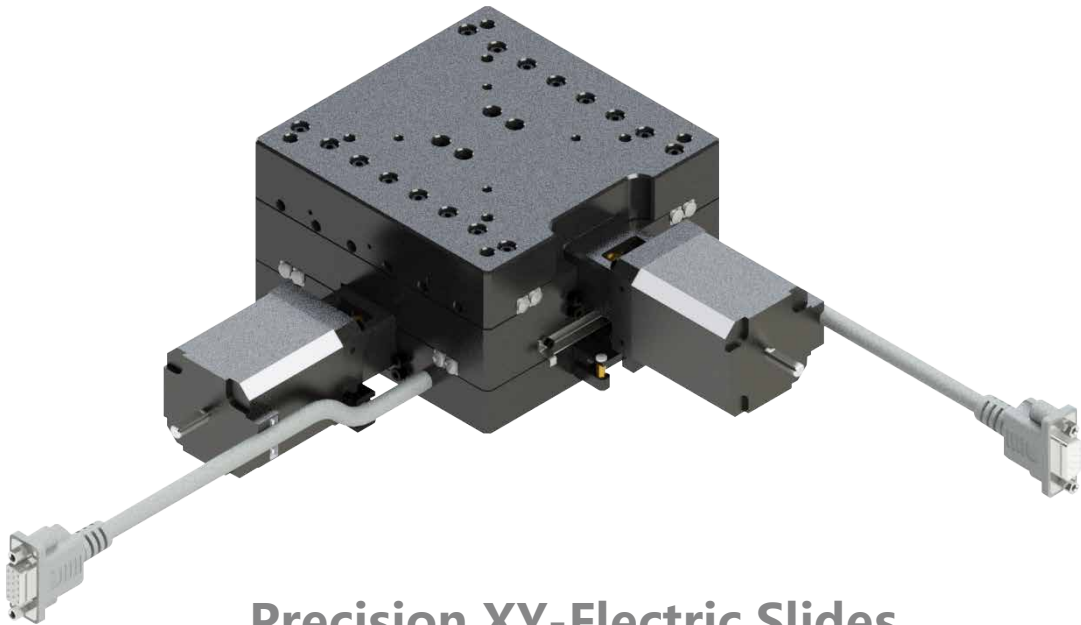

Precision XY-Electric Slides

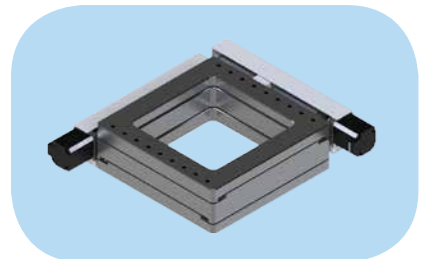

# GXY Model Code

	GXY		-	6.5		-	L		-	B28C	
	Series	Size		Type	Stroke		Outlet Direction	Motor			
	XY Axes	40: 40×40mm	T: Side Drive	6.5: ±6.5mm	L: Left	B28: Dedicated 28 Open Loop Stepper Motor					
XXY		60: 60×60mm	Blank: Standard	10: ±10mm	R: Right	B42: Dedicated 42 Open Loop Stepper Motor					
GXYR		80: 80×80mm		15: ±15mm	Blank: None	BC28: Dedicated 28 Closed Loop Stepper Motor					
GX		100: 100×100mm		20: ±20mm		B28C1: 28 Stepper Motor Connector Φ5-Φ22-Φ32.53-Φ3					
GZ		120: 120×120mm		25: ±25mm		B42C1: 42 Stepper Motor Connector Φ5-Φ22-Φ43.84-Φ3.5					
GTZ		150: 150×150mm		35: ±35mm		S10C2: 100W Servo Motor Connector Φ8-Φ30-Φ46-M4					
GXY				45: ±45mm							

## Technical Parameters

Parameters	Model								
	GXY40-6.5L GXY40-6.5R	GXY60-15L GXY60-15R	GXY60T-10	GXY80-20	GXY100-25	GXY100T-10	GXY120-35	GXY150-45	
Table Size	mm	40×40	60×60	60×60	80×80	100×100	100×100	120×120	150×150
Base Size	mm	40×40	60×60	60×60	80×80	100×100	100×100	120×120	150×150
Height	mm	60	60	55	60	70	55	72	71
Stroke	mm	±6.5	±15	±10	±20	±25	±10	±35	±45
One-way Repeatability	mm	±0.001							
Flatness	mm	0.03							
Screw Lead	mm	1				2			
Suggested Dynamic Load	Horizontal Installation	≤ 10	≤ 30	≤ 30	≤ 50				
	Vertical Installation	≤ 5	≤ 7	≤ 10	≤ 20				
Static Load	kg	≤ 30	≤ 60			≤ 100			
Surface Treatment	Black Anodized								
Weight(no motor)	kg	0.44	0.83	1.2	1.15	1.98	1.2	2.7	4

\* This promotional material is for consultation only, if the information does not match the product entity, the product entity shall prevail, if you have any questions please contact our sales representative  
If there are any upgrades or changes to the product's structure, specifications, dimensions, or parameters, we will not notify you further. Thanks for your understanding

## ■ GXY40-6.5L

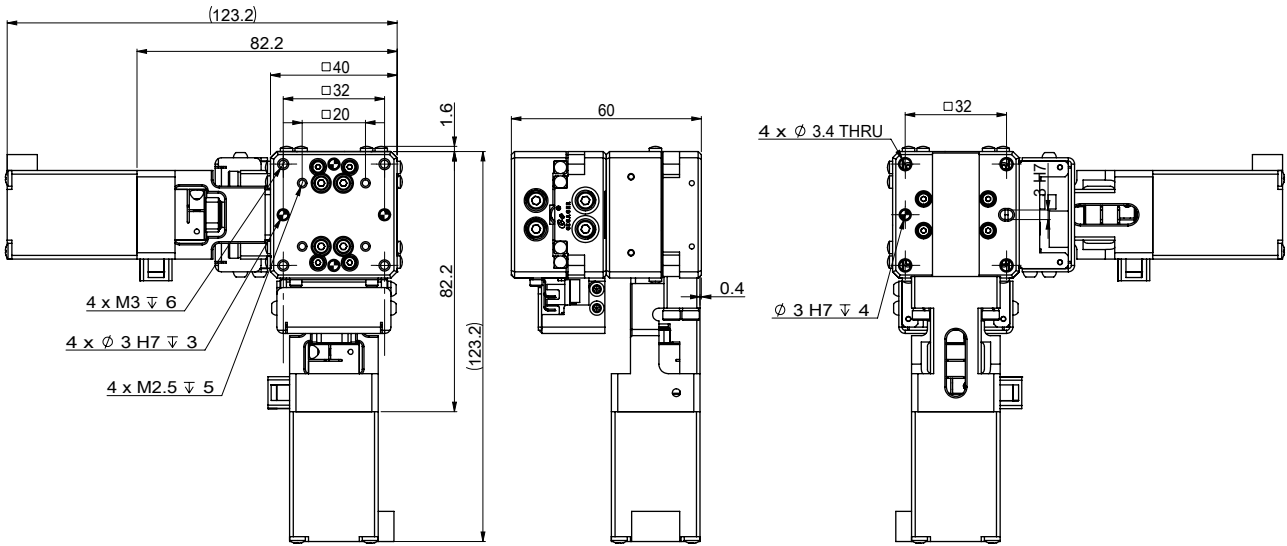

## ■ GXY40-6.5R

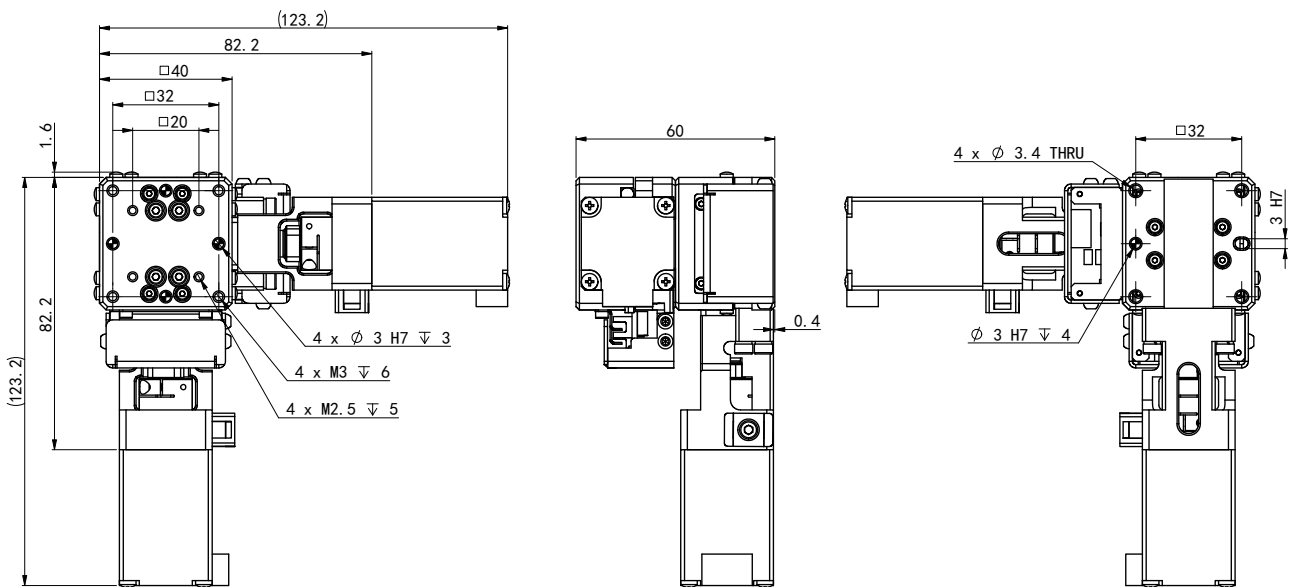

XXY
GXYR
GX
GZ
GTZ
<b>GXY</b>
GR
GYH
GSH
GSR
GSHR
GSA
GSN
GSB
GSG
Parameter
GSZ
GMR
GMC
GMA
GML

■ GXY60-15L

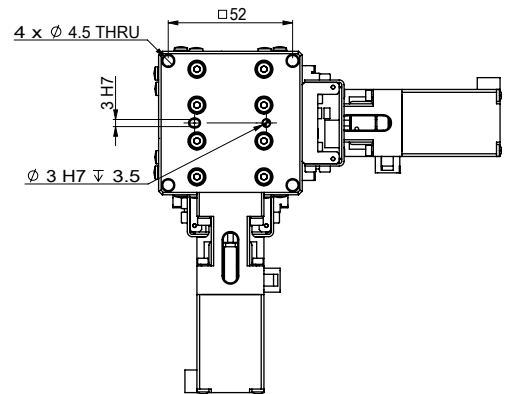
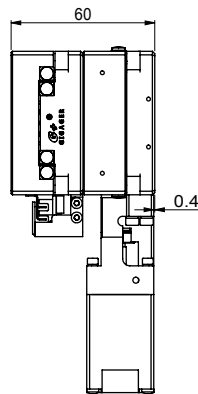
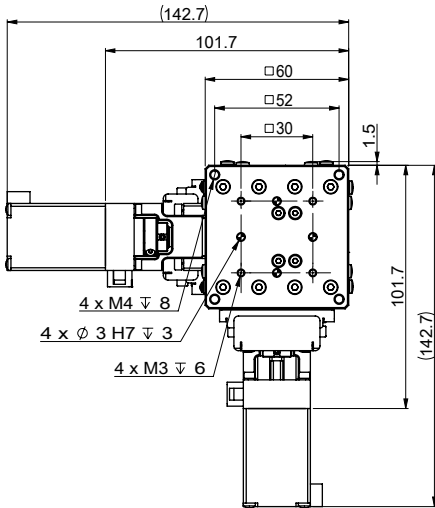

■ GXY60-15R

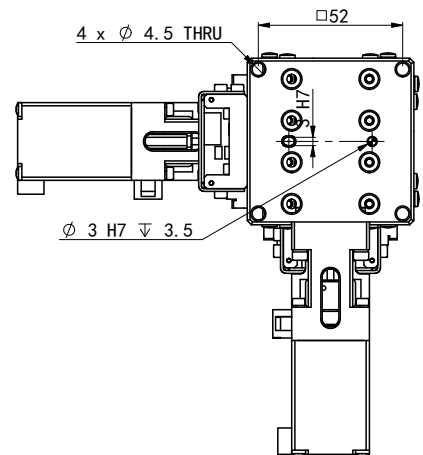
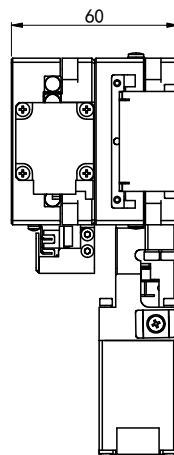
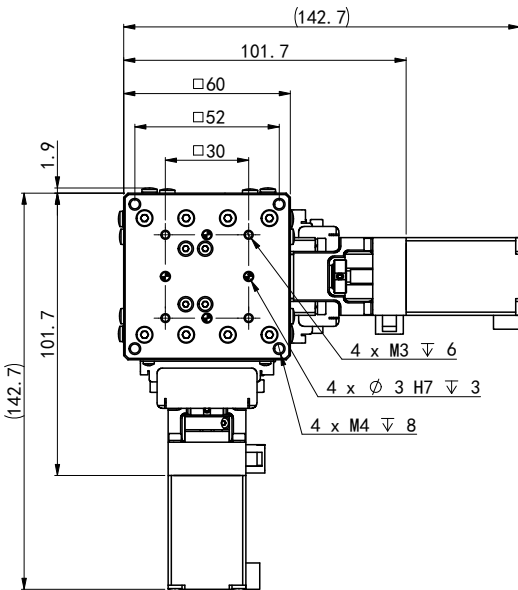

## ■ GXY60T-10

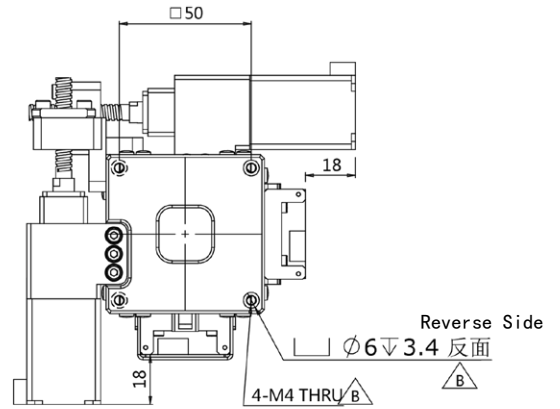
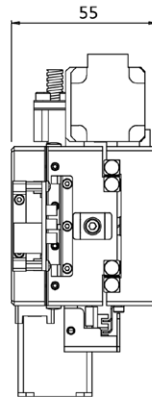
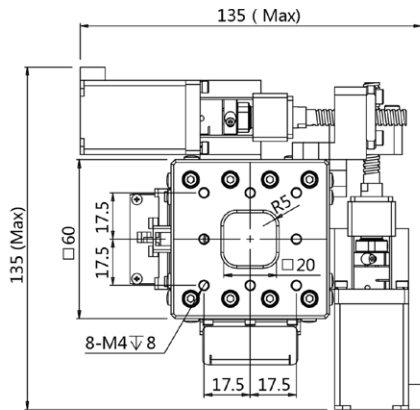
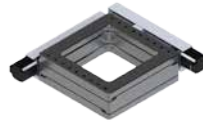

## ■ GXY80-20

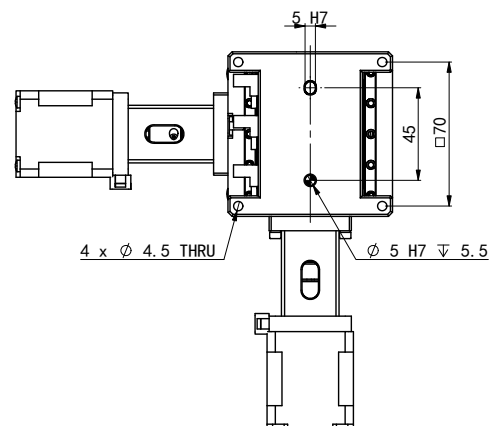
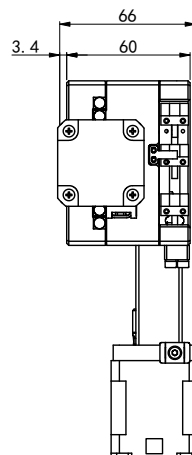
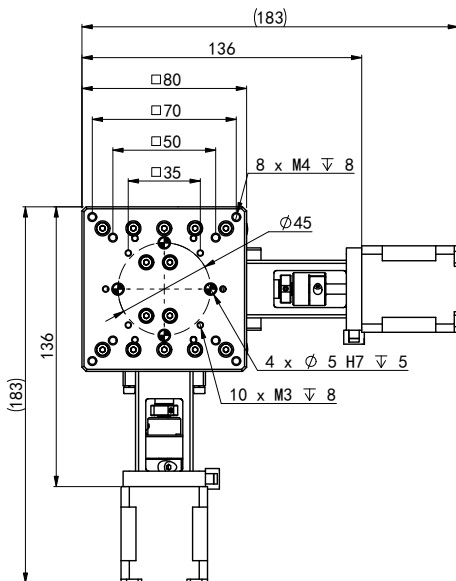

XXY
GXYR
GX
GZ
GTZ
<b>GXY</b>
GR
GYH
GSH
GSR
GSHR
GSA
GSN
GSB
GSG
Parameter
GSZ
GMR
GMC
GMA
GML

■ GXY100-25

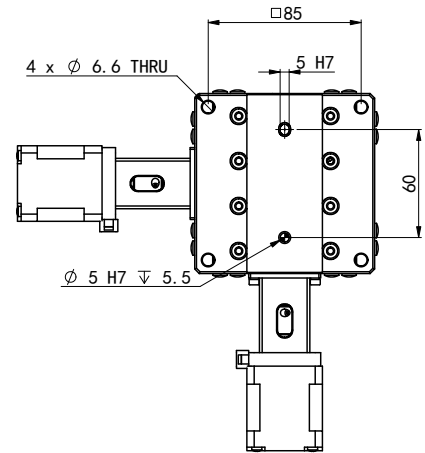
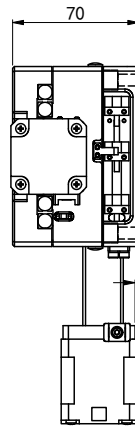
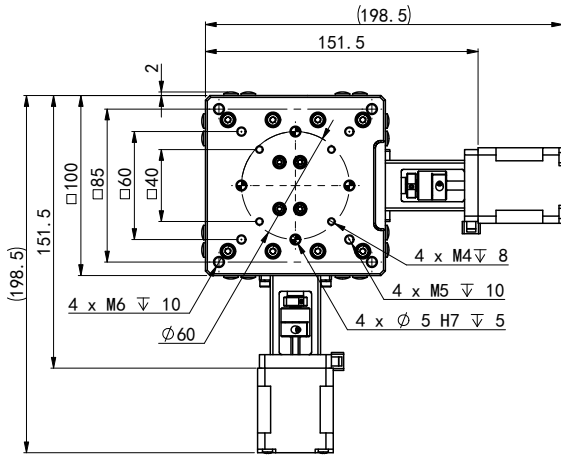

■ GXY100T-10

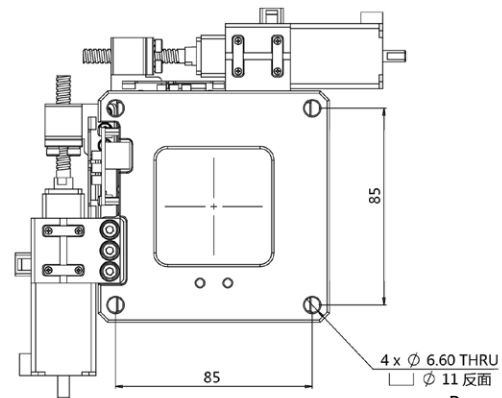
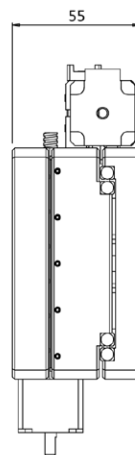
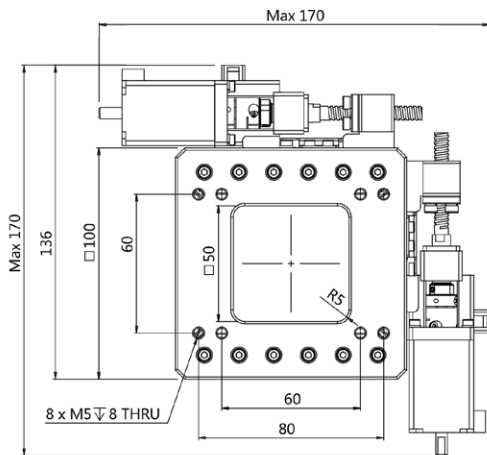
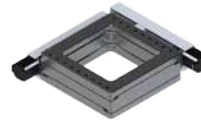

Reverse Side

XXY
GXYR
GX
GZ
GTZ
<b>GXY</b>
GR
GYH
GSH
GSR
GSHR
GSA
GSN
GSB
GSG
Parameter
GSZ
GMR
GMC
GMA
GML

## ■ GXY120-35

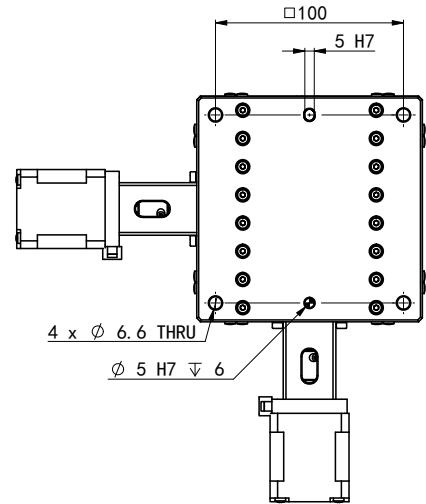
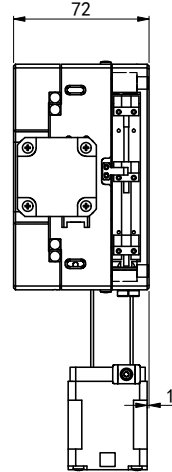
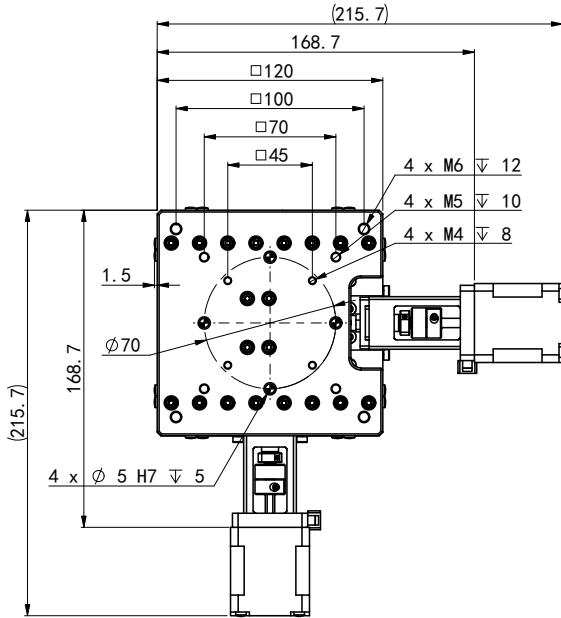

## ■ GXY150-45

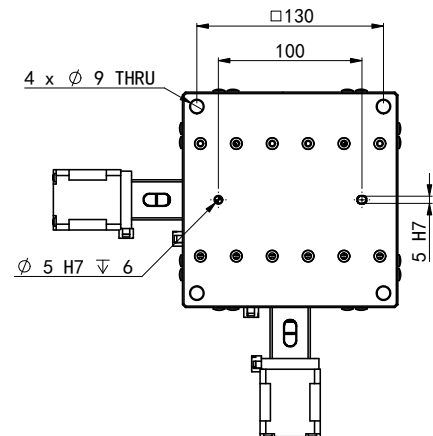
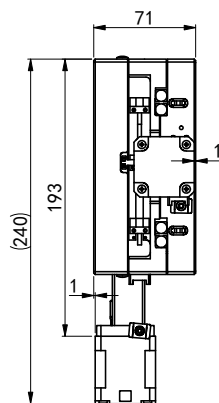
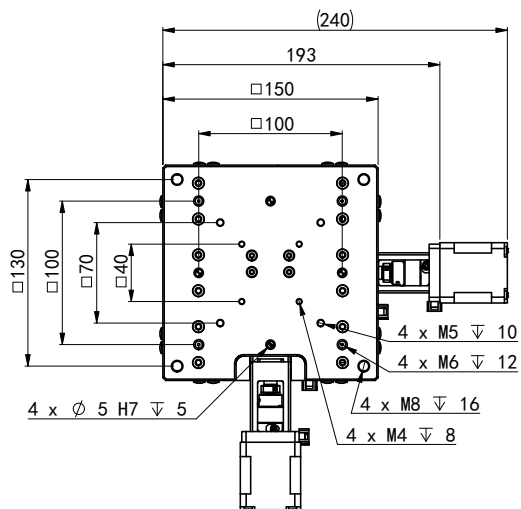

XXY
GXYR
GX
GZ
GTZ
<b>GXY</b>
GR
GYH
GSH
GSR
GSHR
GSA
GSN
GSB
GSG
Parameter
GSZ
GMR
GMC
GMA
GML